

## 2. FRAME/BODY PANELS/EXHAUST SYSTEM

---

SERVICE INFORMATION .....	2-2	REAR FENDER .....	2-5
TROUBLESHOOTING .....	2-2	REFLECTOR (CANADA ONLY) .....	2-6
FUEL TANK SHROUD .....	2-3	MAIN STEP .....	2-6
LEFT SIDE COVER .....	2-4	LEFT CRANKCASE REAR COVER .....	2-7
SEAT .....	2-4	DRIVE CHAIN COVER .....	2-7
NUMBER PLATE .....	2-5	EXHAUST PIPE/MUFFLER .....	2-8
FRONT FENDER .....	2-5		

**SERVICE INFORMATION**

**GENERAL**

- This section covers removal and installation of the body panels, fuel tank and exhaust system.
- Serious burns may result if the exhaust system is not allowed to cool before components are removed or serviced.
- Always replace the exhaust pipe gaskets after removing the exhaust pipe from the engine.
- When installing the exhaust system, loosely install all of the exhaust pipe fasteners first. Always tighten the exhaust clamps first, then tighten the mounting fasteners. If you tighten the mounting fasteners first, the exhaust pipe may not seat properly.
- Always inspect the exhaust system for leaks after installation.

**TORQUE VALUES**

ITEM	Q'TY	THREAD DIA. (mm)	TORQUE N·m (kgf·m, lbf·ft)	REMARKS
Fuel tank shroud special bolt	4	6	10 (1.0, 7)	
Left side cover special bolt	1	6	10 (1.0, 7)	
Rear fender special bolt	3	6	10 (1.0, 7)	
Front reflector mounting nut (Canada only)	2	6	2.5 (0.26, 1.8)	
Fork bottom bridge pinch bolt	2	8	32 (3.3, 24)	
Rear side reflector mounting nut (Canada only)	2	6	2.5 (0.26, 1.8)	
Rear reflector mounting nut (Canada only)	1	5	1.8 (0.18, 1.3)	
Rear reflector stay special bolt (Canada only)	2	6	10 (1.0, 7)	
Main step mounting bolt	4	8	27 (2.8, 20)	
Drive chain cover special bolt	3	6	10 (1.0, 7)	
Muffler mounting bolt	1	8	32 (3.3, 24)	
Exhaust pipe stud bolt	2	8	11 (1.1, 8)	See page 2-8
Muffler cover bolt	1	6	9 (0.9, 6.6)	
Exhaust pipe cover screw	4	5	6 (0.6, 4.4)	
Exhaust pipe cover bolt	3	6	15 (1.5, 11)	
Spark arrester mounting bolt	3	6	10 (1.0, 7)	

**TROUBLESHOOTING**

**Excessive exhaust noise**

- Broken exhaust system
- Exhaust gas leak

**Poor performance**

- Deformed exhaust system
- Exhaust gas leak
- Clogged muffler

# FUEL TANK SHROUD

## REMOVAL/INSTALLATION

### RIGHT SIDE:

Remove the following:

- Bolt [1]/collar [2]
- Two special bolts [3]
- Trim clip [4]

Remove the right fuel tank shroud [5] by releasing the two bosses [6] from the grommets and groove [7] from the hook of the fuel tank.

Installation is in the reverse order of removal.

### TORQUE:

**Fuel tank shroud special bolt:**  
 10 N·m (1.0 kgf·m, 7 lbf·ft)

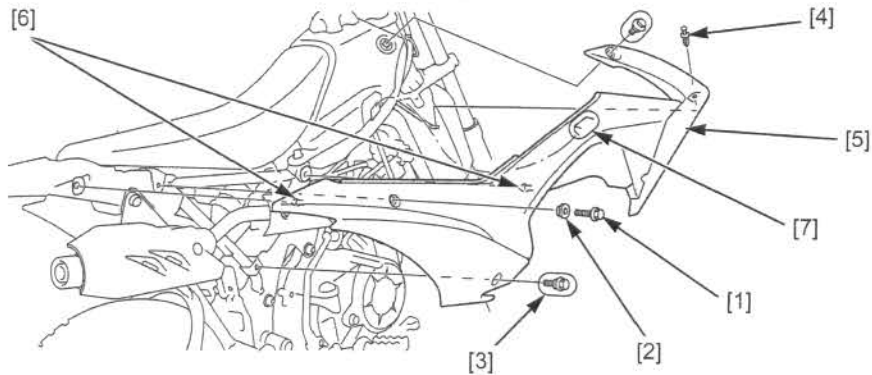

### LEFT SIDE:

Remove the left side cover (page 2-4).

Remove the two special bolts [1] and trim clip [2].

Remove the left fuel tank shroud [3] by releasing the groove [4] from the hook of the fuel tank.

Installation is in the reverse order of removal.

### TORQUE:

**Fuel tank shroud special bolt:**  
 10 N·m (1.0 kgf·m, 7 lbf·ft)

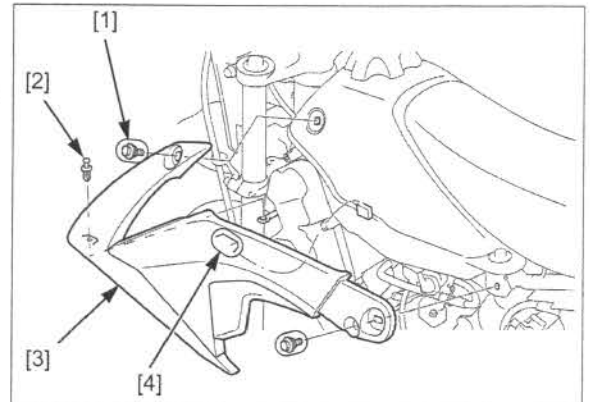

## DISASSEMBLY/ASSEMBLY

Remove the screw [1].

Remove the fuel tank shroud C [2] from the fuel tank shroud B [3] by releasing the hooks [4].

*Right side only:* Remove the screw [5] and fuel tank shroud A [6].

Assembly is in the reverse order of disassembly.

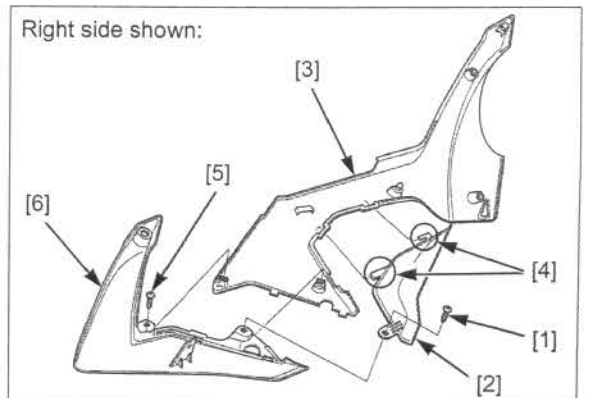

## LEFT SIDE COVER

### REMOVAL/INSTALLATION

Remove the following:

- Bolt [1]/collar [2]
- Special bolt [3]

Remove the left side cover [4] by releasing the two bosses [5] from the grommets.

Installation is in the reverse order of removal.

### TORQUE:

Left side cover special bolt:  
10 N·m (1.0 kgf·m, 7 lbf·ft)

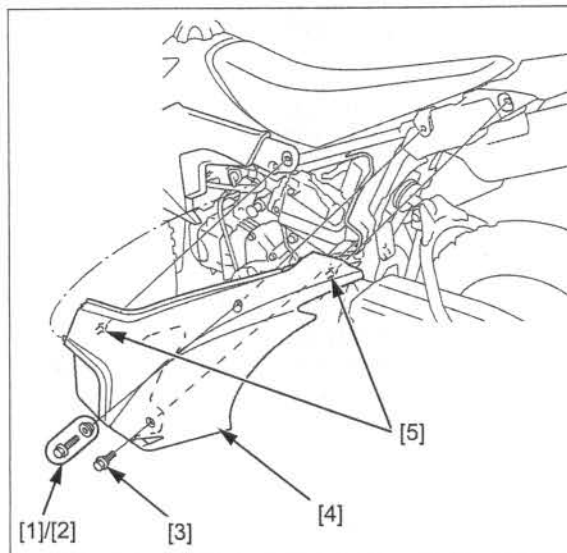

### DISASSEMBLY/ASSEMBLY

Remove the screw [1].

Remove the battery cover [2] from the left side cover [3] by releasing the tab [4].

Assembly is in the reverse order of disassembly.

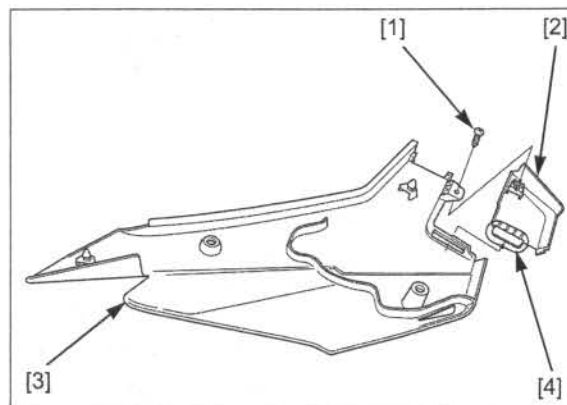

## SEAT

### REMOVAL/INSTALLATION

Remove the following:

- Left side cover (page 2-4)
- Fuel tank shrouds (page 2-3)

Remove the seat [1] by pulling it backward.

Align the seat hook [2] with the seat bracket on the fuel tank and seat prong [3] with the hook on the frame.

Install the removed parts in the reverse order of removal.

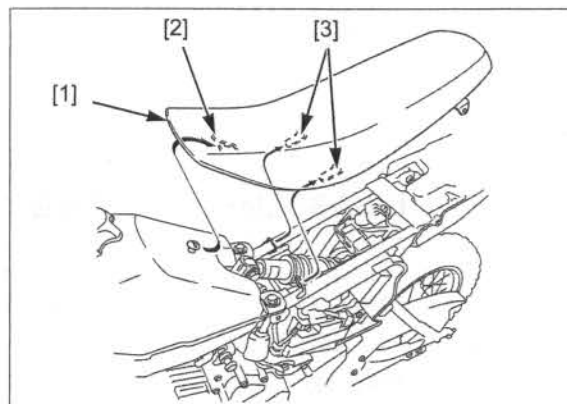

## NUMBER PLATE

### REMOVAL/INSTALLATION

Release the number plate band [1] from the handlebar pad and remove the two special bolts [2].

Remove the number plate [3] by releasing the holes [4] from the boss on the front fender.

Installation is in the reverse order of removal.

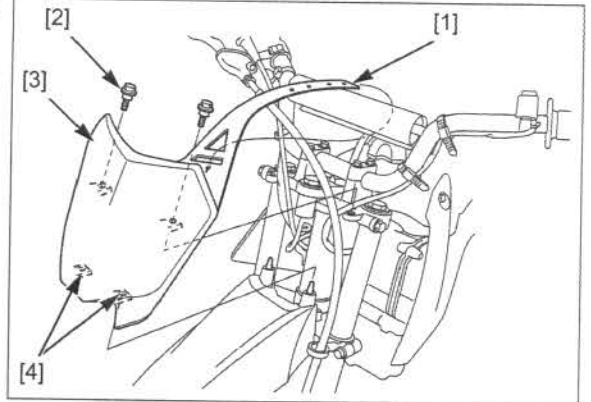

## FRONT FENDER

### REMOVAL/INSTALLATION

Remove the following:

- Three bolts [1]
- Front fender [2]
- Three collars [3]

Installation is in the reverse order of removal.

- Align the bosses [4] of the front fender with holes of the number plate.

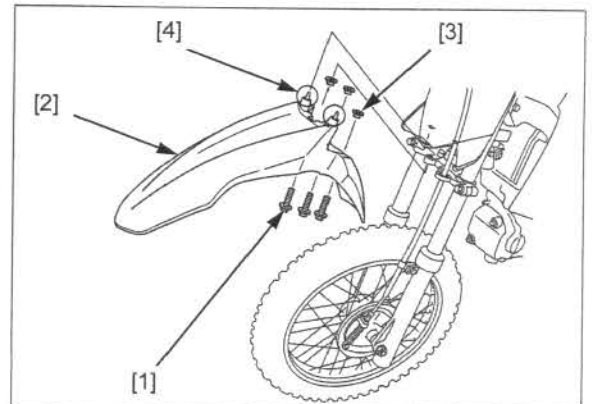

## REAR FENDER

### REMOVAL/INSTALLATION

Remove the ICM (page 4-8).

Remove the three special bolts [1].

Pull the rear fender [2] backward and remove it from the frame pipe.

Installation is in the reverse order of removal.

#### TORQUE:

Rear fender special bolt:  
10 N·m (1.0 kgf·m, 7 lbf·ft)

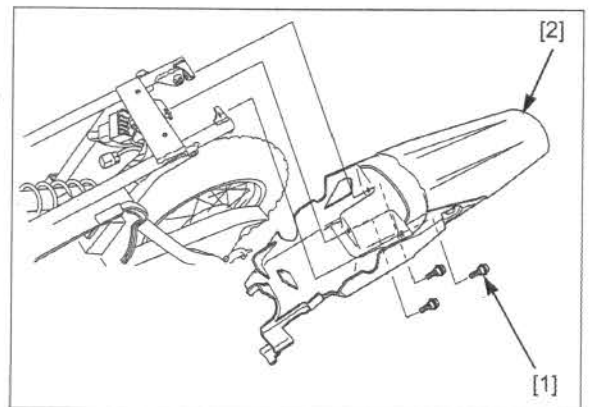

## REFLECTOR (CANADA ONLY)

### REMOVAL/INSTALLATION

#### FRONT

Remove the following:

- Bottom bridge pinch bolt [1]
- Front reflector stay [2]
- Nut [3] and front reflector [4]
- Cable guide [5] (Left side only)

Installation is in the reverse order of removal.

#### TORQUE:

**Front reflector mounting nut:**  
2.5 N·m (0.26 kgf·m, 1.8 lbf·ft)

**Fork bottom bridge pinch bolt:**  
32 N·m (3.3 kgf·m, 24 lbf·ft)

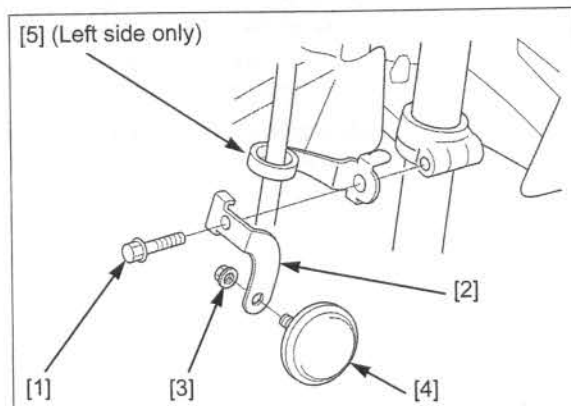

#### REAR

Remove the following:

- Special bolts [1], nuts [2] and rear reflector stay [3]
- Nuts [4] and rear side reflectors [5]
- Nut [6] and rear reflector [7]

Installation is in the reverse order of removal.

#### TORQUE:

**Rear side reflector mounting nut:**  
2.5 N·m (0.26 kgf·m, 1.8 lbf·ft)

**Rear reflector mounting nut:**  
1.8 N·m (0.18 kgf·m, 1.3 lbf·ft)

**Rear reflector stay special bolt:**  
10 N·m (1.0 kgf·m, 7 lbf·ft)

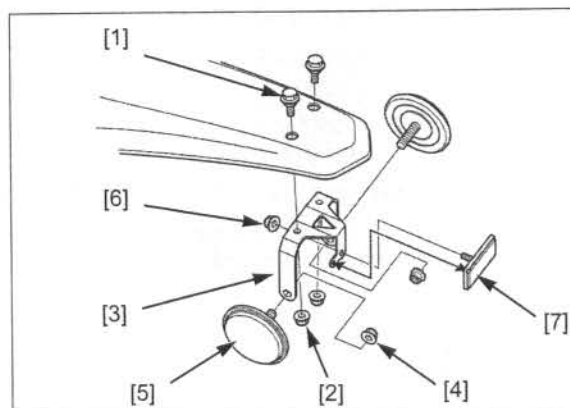

## MAIN STEP

### REMOVAL/INSTALLATION

Support the motorcycle securely with a hoist or equivalent.

Remove the four bolts [1] and main step [2].

Installation is in the reverse order of removal.

#### TORQUE:

**Main step mounting bolt:**  
27 N·m (2.8 kgf·m, 20 lbf·ft)

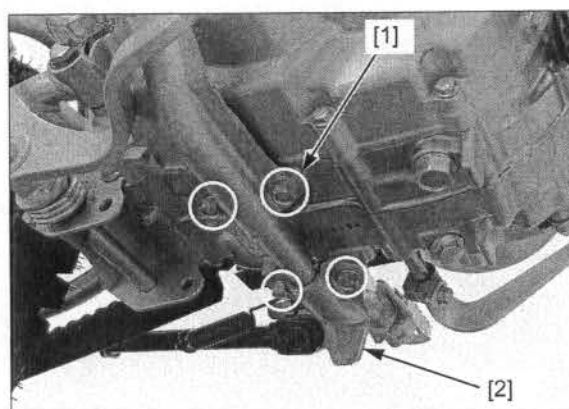

## LEFT CRANKCASE REAR COVER

### REMOVAL/INSTALLATION

Remove the two bolts [1], left crankcase rear cover [2] and set plate [3].

Installation is in the reverse order of removal.

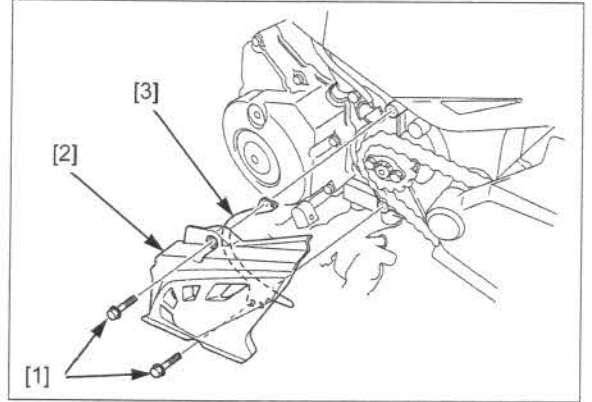

## DRIVE CHAIN COVER

### REMOVAL/INSTALLATION

Remove the following:

- Three special bolts [1]
- Two bolts [2]/collars [3]
- Drive chain cover [4]
- Drive chain guard [5]

Installation is in the reverse order of removal.

#### TORQUE:

Drive chain cover special bolt:  
10 N·m (1.0 kgf·m, 7 lbf·ft)

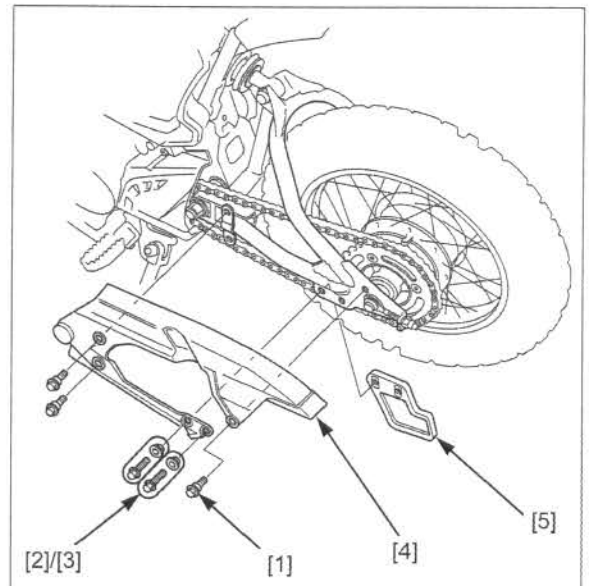

## EXHAUST PIPE/MUFFLER

### REMOVAL/INSTALLATION

Remove the following:

- Right fuel tank shroud (page 2-3)
- Two exhaust pipe joint nuts [1]
- Muffler mounting bolt [2]
- Exhaust pipe/muffler [3]
- Gasket [4]

Install a new gasket.

Set the exhaust pipe/muffler and install the muffler mounting bolt and joint nuts.

Tighten the joint nuts first then the mounting bolt to the specified torque.

#### TORQUE:

**Muffler mounting bolt:**  
32 N·m (3.3 kgf·m, 24 lbf·ft)

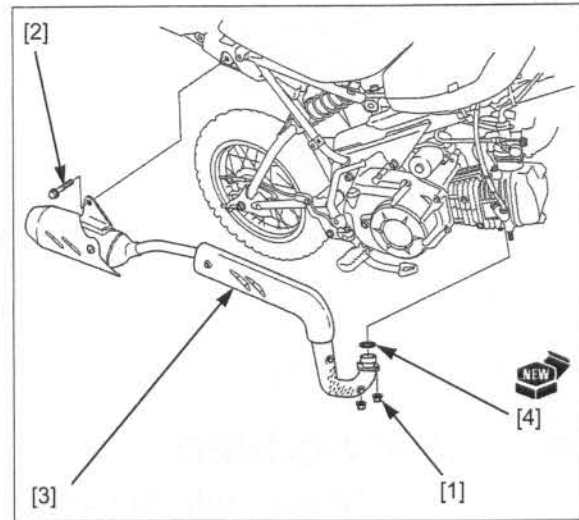

### EXHAUST PIPE STUD BOLT

Thread two nuts to the stud bolt [1] and tighten them together, then use a wrench on them to turn the stud bolt out.

Install and tighten new stud bolts into the cylinder head to the specified torque.

**TORQUE: 11 N·m (1.1 kgf·m, 8 lbf·ft)**

After tightening the stud bolts, check that the incomplete threads [2] is buried into the cylinder head.

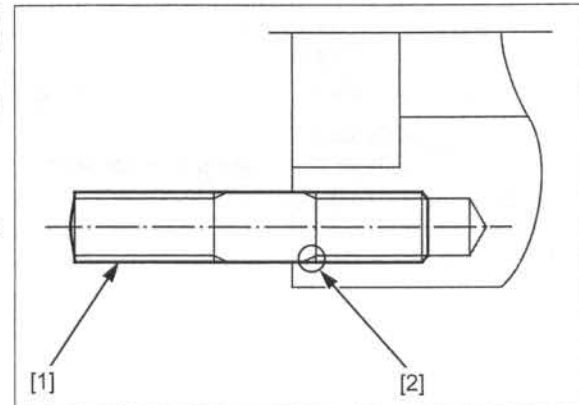

### DISASSEMBLY/ASSEMBLY

- Replace the gasket with a new one.

